

PROJECT
TYPE
CATALOG #

# 10-ALDI4-5CCT

4FT ARCHITECTURAL LINEAR DIRECT-INDIRECT LUMEN & KELVIN SELECTABLE

## HOUSING

- Premium powder-coat, sheet metal stamping, white or black housing.

## ELECTRICAL

- Operating temperature (ambient):  
-20°C to 50°C (-4°F to 122°F) when fixture is mounted at least 18" from ceiling;  
-20°C to 40°C (-4°F to 104°F) when surface mounted.
- Universal 120-277V AC voltage (50-60Hz) is standard.
- 0-10VDC dimming drivers are standard.
- Toolless linking of up to 10 fixtures / connectors @120V.
- Power cord sold separately, required for suspension, cable and T-grid mounting.
- Input transient surge protection = 2.5kV.
- Power factor > 0.90.
- Total Harmonic distortion < 20%.

## OPTICAL SYSTEM

- PMMA Lens.
- Field selectable 2700k(soft white), 3000k(warm white), 3500k(warm/neutral white), 4000k (neutral white) and 5000k (cool white) color temperatures\*.
- Four selectable light output settings provide 2,396 to 5,078 nominal lumens (see lumen tables on page 5)\*.
- Long-life LEDs provide 175,000 hours of operation with at least 70% of initial lumen output (L70), and 53,000 hours with at least 90% of initial lumen output (L90)\*\*.
- LED color maintenance < -0.0036 chromaticity shift ( $\Delta u'v'$ ) over the initial 6,000 hours of operation.
- Color rendering index > 80.

## MOUNTING+

- Optional recessed mount kit.
- Optional surface /wall mount kit.
- Optional cable mount kit.
- Optional suspension mount kit.
- Optional T-Grid suspension mount kit.

+ Mounting means required and sold separately.

## CODE COMPLIANCE

- cULus listed for damp locations.
- Complies with FCC part 15, class A.

## WARRANTY

- 5-year warranty on all electronics and housing.

\* Default kelvin temperature 4000k and highest lumen output.  
\*\* L70 & L90 hours are IES TM-21-11 calculated hours.

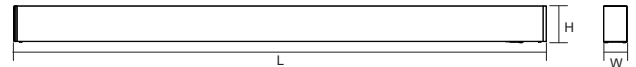

Model	Size (inches) & Weight (lbs)			
	L (in)	W (in)	H (in)	Weight
10-ALDI4-5432L-5CCT	48.15	2.13	3.33	5.53
10-ALDI-CONNECT-L	13.13	13.13	3.3	2.98
10-ALDI-CONNECT-T	13.13	13.43	3.3	2.98
10-ALDI-CONNECT-X	13.43	13.43	3.3	2.98



## PRODUCT PARAMETERS

SERIES	NOMINAL LUMEN OUTPUT (Selectable)	KELVIN (Selectable)	HOUSING COLOR
10-ALDI4	5432L =5,000 / 4,000 / 3,000 / 2,000 lm	5CCT 2700K / 3000K / 3500K / 4000K / 5000K	WHT White BLK Black



PROJECT
TYPE
CATALOG #

# 10-ALDI4-5CCT

4FT ARCHITECTURAL LINEAR DIRECT-INDIRECT LUMEN & KELVIN SELECTABLE

## ACCESSORIES (order separately)

### Connectors

- 10-ALDI-CONNECT-L-WHT = "L" shape Connector for 10-ALDI4-5432L-5CCT, White
- 10-ALDI-CONNECT-L-BLK = "L" shape Connector for 10-ALDI4-5432L-5CCT, Black
- 10-ALDI-CONNECT-T-WHT = "T" shape Connector for 10-ALDI4-5432L-5CCT, White
- 10-ALDI-CONNECT-T-BLK = "T" shape Connector for 10-ALDI4-5432L-5CCT, Black
- 10-ALDI-CONNECT-X-WHT = "X" shape Connector for 10-ALDI4-5432L-5CCT, White
- 10-ALDI-CONNECT-X-BLK = "X" shape Connector for 10-ALDI4-5432L-5CCT, Black

### Power Cable

- 10-ALDI-CORD-WHT = 4' Power Cord for 10-ALDI4-5432L-5CCT, White
- 10-ALDI-CORD-BLK = 4' Power Cord for 10-ALDI4-5432L-5CCT, Black
- 10-ALDI-CORD-WHT-15C5 = 15' Power Cord for 10-ALDI4-5432L-5CCT, White
- 10-ALDI-CORD-BLK-15C5 = 15' Power Cord for 10-ALDI4-5432L-5CCT, Black

### Mounting Methods

- 10-ALDI4-MT-RECESSED = Recessed Mount Kit for 10-ALDI4-5432L-5CCT
- 10-ALDI4-MT-T-GRID-WHT = T-Grid Mount Kit for 10-ALDI4-5432L-5CCT, White
- 10-ALDI4-MT-T-GRID-BLK = T-Grid Mount Kit for 10-ALDI4-5432L-5CCT, Black
- 10-ALDI-MT-SUSPENSION-WHT = Suspension Mount Kit for 10-ALDI4-5432L-5CCT, White
- 10-ALDI-MT-SUSPENSION-BLK = Suspension Mount Kit for 10-ALDI4-5432L-5CCT, Black
- 10-ALDI-MT-SURFACE-WHT = Surface & Wall Mount Kit for 10-ALDI4-5432L-5CCT, White
- 10-ALDI-MT-SURFACE-BLK = Surface & Wall Mount Kit for 10-ALDI4-5432L-5CCT, Black
- 10-ALDI-MT-CABLE = Cable Mount Kit for 10-ALDI4-5432L-5CCT L, T & X connectors

## COMPATIBLE DIMMERS & CONTROLS

Manufacturer	Model Number	Dimmer Range	Load Switching Capacity
Best Lighting	DWS-010V-T	10%-100%	600W
Best Lighting	DWS-010V-D	10%-100%	600W
Leviton	IP710-LFZ	10%-100%	1200W
Lutron	DVSTV	10%-100%	450W

PROJECT
TYPE
CATALOG #

# 10-ALDI4-5CCT

4FT ARCHITECTURAL LINEAR DIRECT-INDIRECT LUMEN & KELVIN SELECTABLE

## CONNECTOR DIMENSIONS

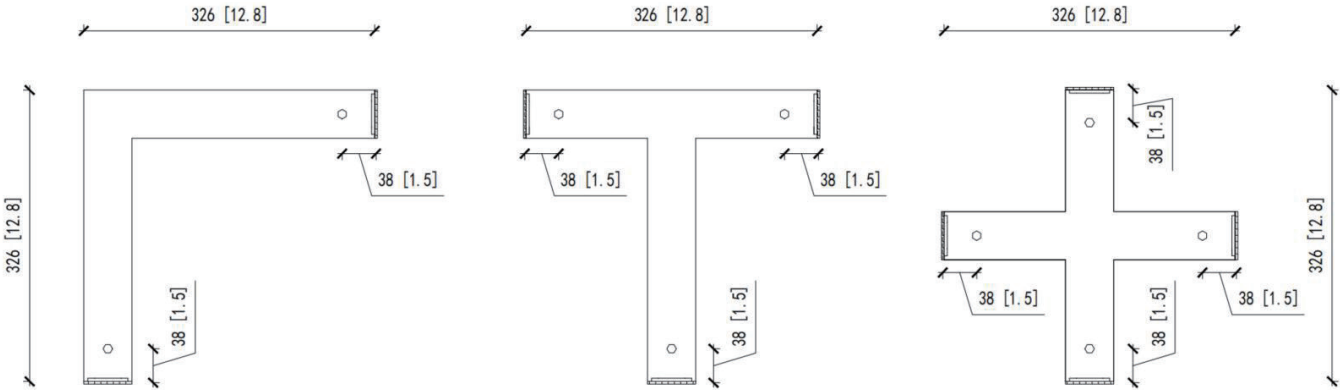

## INSTALLATION ACCESSORIES

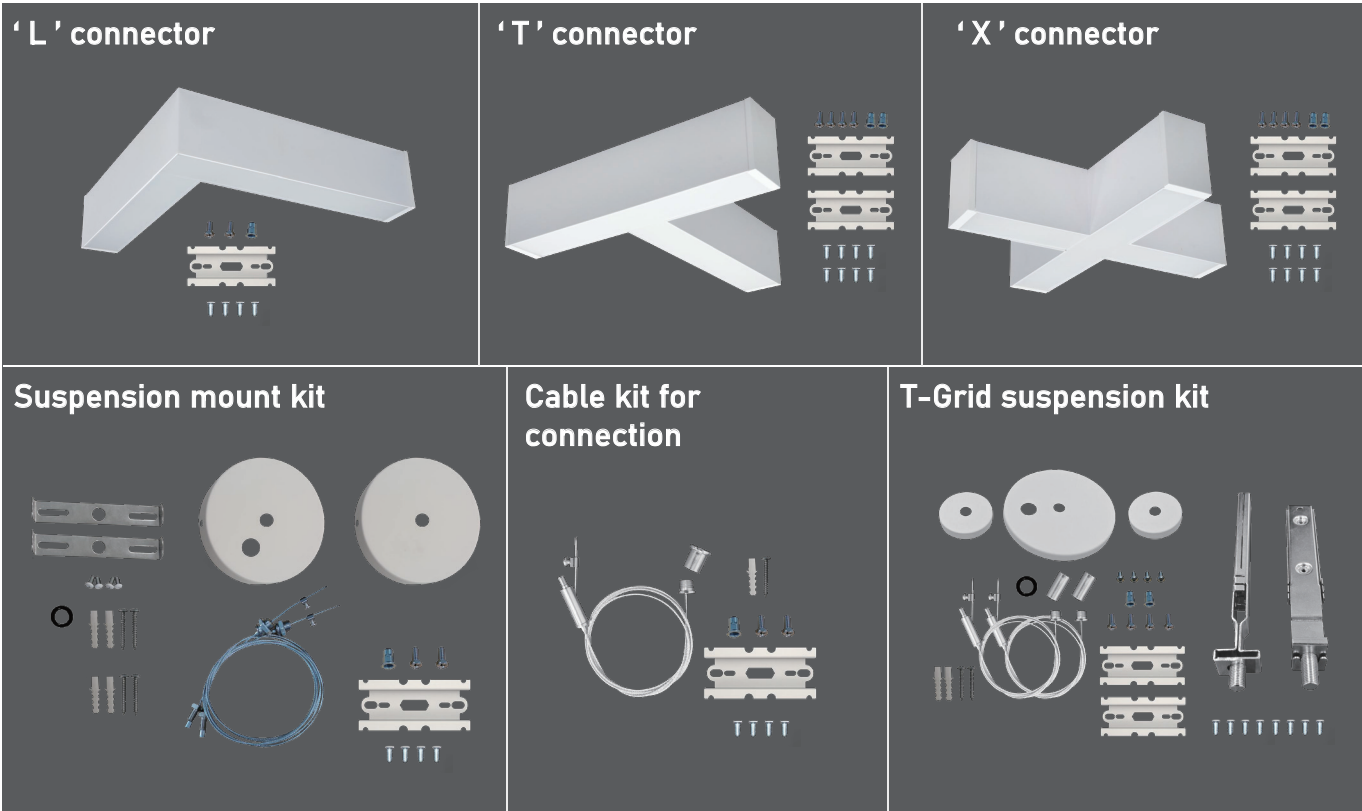

PROJECT
TYPE
CATALOG #

# 10-ALDI4-5CCT

4FT ARCHITECTURAL LINEAR DIRECT-INDIRECT LUMEN & KELVIN SELECTABLE

**Recessed mount kit**

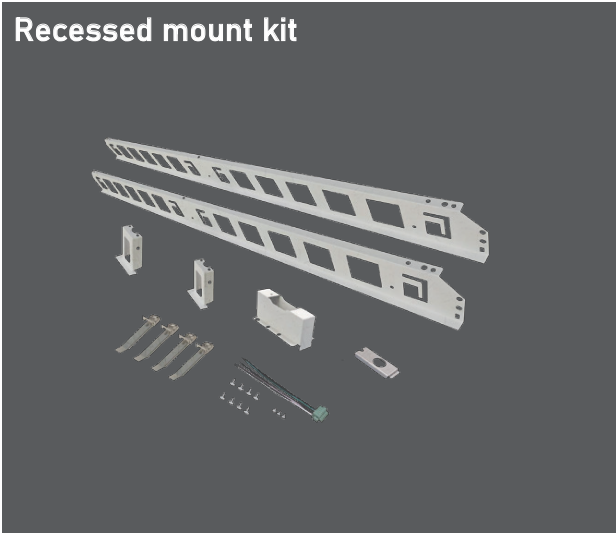

**Surface mount & Wall mount kit**

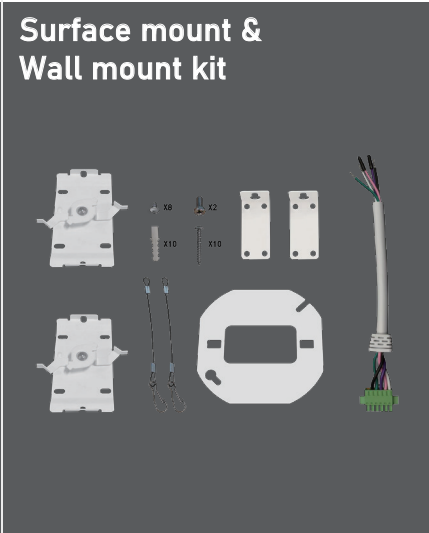

**Power cord**

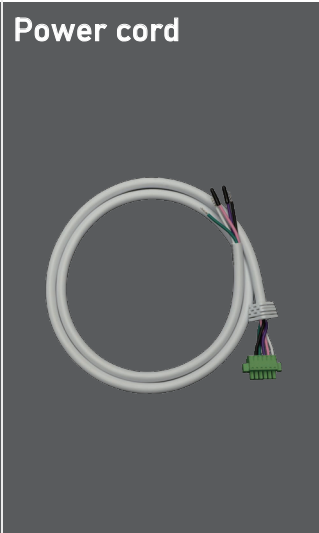



PROJECT
TYPE
CATALOG #

# 10-ALDI4-5CCT

4FT ARCHITECTURAL LINEAR DIRECT-INDIRECT LUMEN & KELVIN SELECTABLE

## LUMEN TABLES\* & ELECTRICAL DATA

Series	Measurements	100% Down / 0% Up					70% Down / 30% Up					50% Down / 50% Up				
		2700K	3000K	3500K	4000K	5000K	2700K	3000K	3500K	4000K	5000K	2700K	3000K	3500K	4000K	5000K
10-ALDI4-543 2L-5CCT- WHT	Lumens	4,617	4,642	4,673	4,698	4,729	4,679	4,683	4,715	4,735	4,764	4,738	4,759	4,791	4,809	4,843
	Watt	40.28	40.25	40.27	40.4	40.29	41.36	41.45	41.42	41.43	41.26	41.11	41.32	41.27	41.25	41.01
	Efficacy	114.62	115.34	116.05	116.29	117.37	113.12	112.99	113.84	114.28	115.47	115.25	115.17	116.08	116.58	118.09
	Input Current (A)	120V	0.34	0.34	0.34	0.34	0.34	0.34	0.35	0.35	0.35	0.34	0.34	0.34	0.34	0.34
240V		0.17	0.17	0.17	0.17	0.17	0.17	0.17	0.17	0.17	0.17	0.17	0.17	0.17	0.17	0.17
277V		0.15	0.15	0.15	0.15	0.15	0.15	0.15	0.15	0.15	0.15	0.15	0.15	0.15	0.15	0.15

Series	Measurements	100% Down / 0% Up					70% Down / 30% Up					50% Down / 50% Up				
		2700K	3000K	3500K	4000K	5000K	2700K	3000K	3500K	4000K	5000K	2700K	3000K	3500K	4000K	5000K
10-ALDI4-54 32L-5CCT -BLK	Lumens	4,903	4,948	5,053	5,078	4,949	4,842	4,897	5,015	5,044	4,896	4,761	4,799	4,942	5,008	4,852
	Watt	41.81	40.76	41.96	40.77	41.78	42.09	41.48	42.21	41.49	42.03	42.33	42.49	42.5	42.5	42.3
	Efficacy	117.26	121.39	120.43	124.55	118.47	115.03	118.05	118.82	121.58	116.50	112.47	112.94	116.28	117.84	114.70
	Input Current (A)	120V	0.35	0.34	0.35	0.34	0.35	0.35	0.35	0.35	0.35	0.35	0.35	0.35	0.35	0.35
240V		0.17	0.17	0.17	0.17	0.17	0.18	0.17	0.18	0.17	0.18	0.18	0.18	0.18	0.18	0.18
277V		0.15	0.15	0.15	0.15	0.15	0.15	0.15	0.15	0.15	0.15	0.15	0.15	0.15	0.15	0.15

\* Contact factory for additional performance details.

# 10-ALDI4-5CCT

4FT ARCHITECTURAL LINEAR DIRECT-INDIRECT LUMEN & KELVIN SELECTABLE

PROJECT
TYPE
CATALOG #

## PHOTOMETRIC DATA

### 10-ALDI4-5432L-5CCT-WHT (100% Down / 0% Up)

#### Luminaire Data

Description	4' Linear direct/indirect Lumen/kelvin select
Total Lumens	4,635
Input Wattage	40
Efficacy (lm/W)	116
Spacing Criterion (0-180°)	1.24
Spacing Criterion (90-270°)	1.22

#### Zonal Lumen Summary

Zone	Lumens	%Fixt	Zone	Lumens	%Fixt
0-20°	621	13.4%	60-80°	866	18.7%
0-30°	1,304	28.1%	70-80°	318	6.9%
0-40°	2,111	45.5%	80-90°	98	2.1%
0-60°	3,655	78.9%	90-110°	4	0.1%
0-80°	4,521	97.5%	90-120°	5	0.1%
0-90°	4,619	99.7%	90-130°	7	0.2%
10-90°	4,457	96.2%	90-150°	11	0.2%
20-40°	1,490	32.2%	90-180°	16	0.3%
20-50°	2,308	49.8%	110-180°	12	0.3%
40-70°	2,092	45.1%	0-180°	4,635	100.0%

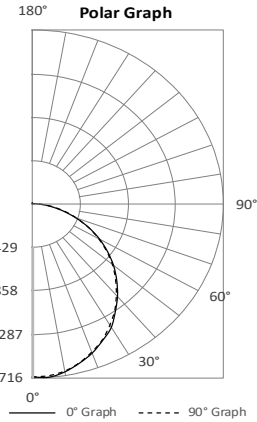

Photometric based on 2700k and highest lumen setting

### 10-ALDI4-5432L-5CCT-WHT (70% Down / 30% Up)

#### Luminaire Data

Description	4' Linear direct/indirect Lumen/kelvin select
Total Lumens	4,717
Input Wattage	41
Efficacy (lm/W)	116
Spacing Criterion (0-180°)	1.24
Spacing Criterion (90-270°)	1.22

#### Zonal Lumen Summary

Zone	Lumens	%Fixt	Zone	Lumens	%Fixt
0-20°	446	9.5%	60-80°	629	13.3%
0-30°	937	19.9%	70-80°	232	4.9%
0-40°	1,517	32.2%	80-90°	73	1.6%
0-60°	2,630	55.8%	90-110°	116	2.5%
0-80°	3,259	69.1%	90-120°	287	6.1%
0-90°	3,332	70.6%	90-130°	512	10.9%
10-90°	3,216	68.2%	90-150°	1,003	21.3%
20-40°	1,071	22.7%	90-180°	1,385	29.4%
20-50°	1,660	35.2%	110-180°	1,269	26.9%
40-70°	1,510	32.0%	0-180°	4,717	100.0%

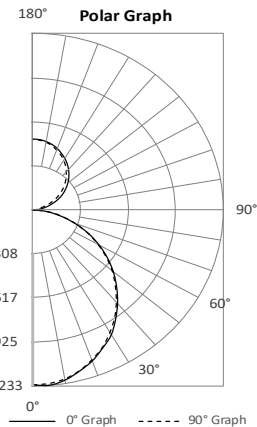

Photometric based on 2700k and highest lumen setting

### 10-ALDI4-5432L-5CCT-WHT (50% Down / 50% Up)

#### Luminaire Data

Description	4' Linear direct/indirect Lumen/kelvin select
Total Lumens	4,741
Input Wattage	41
Efficacy (lm/W)	115
Spacing Criterion (0-180°)	N.A.
Spacing Criterion (90-270°)	N.A.

#### Zonal Lumen Summary

Zone	Lumens	%Fixt	Zone	Lumens	%Fixt
0-20°	316	6.7%	60-80°	449	9.5%
0-30°	663	14.0%	70-80°	167	3.5%
0-40°	1,073	22.6%	80-90°	55	1.2%
0-60°	1,862	39.3%	90-110°	190	4.0%
0-80°	2,311	48.7%	90-120°	483	10.2%
0-90°	2,366	49.9%	90-130°	872	18.4%
10-90°	2,283	48.2%	90-150°	1,717	36.2%
20-40°	758	16.0%	90-180°	2,375	50.1%
20-50°	1,174	24.8%	110-180°	2,185	46.1%
40-70°	1,071	22.6%	0-180°	4,741	100.0%

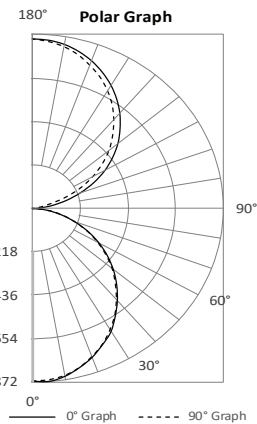

Photometric based on 2700k and highest lumen setting

# 10-ALDI4-5CCT

4FT ARCHITECTURAL LINEAR DIRECT-INDIRECT LUMEN & KELVIN SELECTABLE

PROJECT
TYPE
CATALOG #

## 10-ALDI4-5432L-5CCT-BLK (100% Down / 0% Up)

### Luminaire Data

Description	4' Linear direct/indirect Lumen/kelvin select
Total Lumens	4,903
Input Wattage	42
Efficacy (lm/W)	117
Spacing Criterion (0-180°)	1.22
Spacing Criterion (90-270°)	1.18

### Zonal Lumen Summary

Zone	Lumens	%Fixt	Zone	Lumens	%Fixt
0-20°	677	13.8%	60-80°	889	18.1%
0-30°	1,418	28.9%	70-80°	320	6.5%
0-40°	2,287	46.6%	80-90°	85	1.7%
0-60°	3,929	80.1%	90-110°	0	0.0%
0-80°	4,818	98.3%	90-120°	0	0.0%
0-90°	4,903	100.0%	90-130°	0	0.0%
10-90°	4,726	96.4%	90-150°	0	0.0%
20-40°	1,610	32.8%	90-180°	0	0.0%
20-50°	2,485	50.7%	110-180°	0	0.0%
40-70°	2,212	45.1%	0-180°	4,903	100.0%

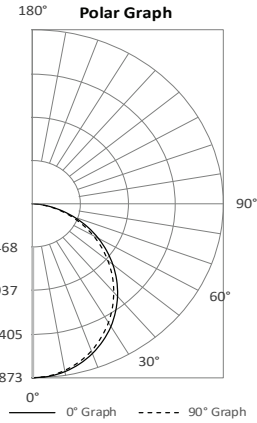

Photometric based on 2700k and highest lumen setting

## 10-ALDI4-5432L-5CCT-BLK (70% Down / 30% Up)

### Luminaire Data

Description	4' Linear direct/indirect Lumen/kelvin select
Total Lumens	4,842
Input Wattage	42
Efficacy (lm/W)	115
Spacing Criterion (0-180°)	1.22
Spacing Criterion (90-270°)	1.18

### Zonal Lumen Summary

Zone	Lumens	%Fixt	Zone	Lumens	%Fixt
0-20°	462	9.5%	60-80°	605	12.5%
0-30°	968	20.0%	70-80°	217	4.5%
0-40°	1,560	32.2%	80-90°	56	1.2%
0-60°	2,680	55.4%	90-110°	89	1.8%
0-80°	3,285	67.8%	90-120°	255	5.3%
0-90°	3,342	69.0%	90-130°	490	10.1%
10-90°	3,221	66.5%	90-150°	1,043	21.5%
20-40°	1,098	22.7%	90-180°	1,500	31.0%
20-50°	1,695	35.0%	110-180°	1,411	29.1%
40-70°	1,508	31.1%	0-180°	4,842	100.0%

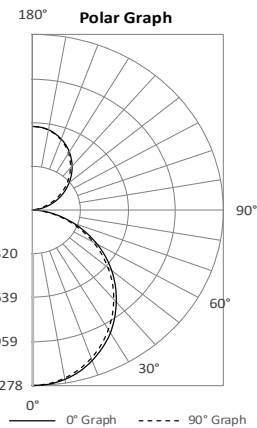

Photometric based on 2700k and highest lumen setting

## 10-ALDI4-5432L-5CCT-BLK (50% Down / 50% Up)

### Luminaire Data

Description	4' Linear direct/indirect Lumen/kelvin select
Total Lumens	4,761
Input Wattage	42
Efficacy (lm/W)	112
Spacing Criterion (0-180°)	N.A.
Spacing Criterion (90-270°)	N.A.

### Zonal Lumen Summary

Zone	Lumens	%Fixt	Zone	Lumens	%Fixt
0-20°	317	6.7%	60-80°	414	8.7%
0-30°	664	14.0%	70-80°	148	3.1%
0-40°	1,071	22.5%	80-90°	38	0.8%
0-60°	1,839	38.6%	90-110°	150	3.1%
0-80°	2,252	47.3%	90-120°	424	8.9%
0-90°	2,290	48.1%	90-130°	812	17.1%
10-90°	2,207	46.4%	90-150°	1,720	36.1%
20-40°	754	15.8%	90-180°	2,471	51.9%
20-50°	1,163	24.4%	110-180°	2,322	48.8%
40-70°	1,033	21.7%	0-180°	4,761	100.0%

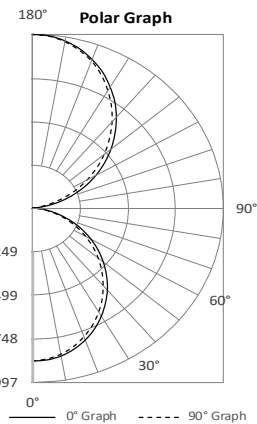

Photometric based on 2700k and highest lumen setting