

# 08-DDAL

LED DUSK-TO-DAWN

PROJECT
TYPE
CATALOG #

## HOUSING

- Die cast aluminum housing with gray powder coat finish.
- Polycarbonate lens.

## ELECTRICAL

- Universal 120-277V AC voltage (50-60Hz).
- Power factor > 0.90.
- Total harmonic distortion < 20%.

## OPTICAL SYSTEM

- Available in 5000k (cool white) color temperature.
- LED color maintenance < 0.003 chromaticity shift ( $\Delta u'v'$ ) over the initial 6,000 hours of operation.
- LED chromaticity based on < 5-step ANSI quadrangles.
- Color rendering index > 80.
- Long-life LEDs provide 163,000 hours of operation with at least 70% of initial lumen output (L70), and 50,000 hours with at least 90% of initial lumen output (L90).\*\*
- Provides 4,900 nominal lumens and draws 37 nominal watts (133 lumens per watt).
- NEMA photocell receptable & photocell are standard.

## MOUNTING

- Easy installation in new construction or retrofit

## CODE COMPLIANCE

- cULus listed for wet locations in ambient temperatures from -40°C to 45°C (-40°F to 113°F).
- Complies with IEC61000-4-5, input transient surge protection (4kV).
- Complies with FCC Part 15, class A.
- IP65 rated for ingress protection.
- 4kV surge protection.

## WARRANTY

- 5-year warranty on all electronics and housing.

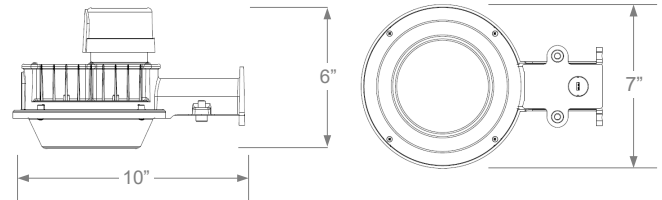

WEIGHT = 3LBS

## OPTIONAL MOUNTING ARM

- Optional powder-coated steel mounting arm attaches to poles or walls.
- Mounting bracket included.

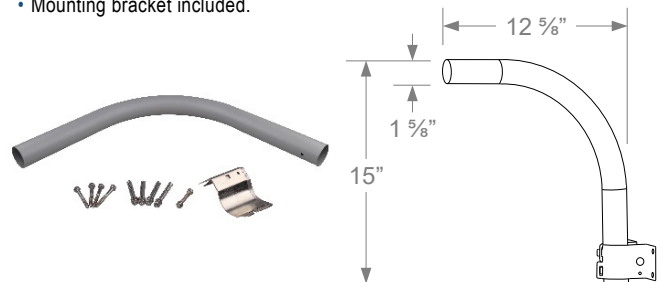

\*L<sub>70</sub> hours are IES TM-21-11 calculated hours

## PRODUCT PARAMETERS

SERIES	NOMINAL LUMEN OUTPUT	COLOR TEMP	PHOTOCELL	ACCESSORIES (ORDER SEPARATELY)
08-DDAL	5L = 5,000	5K = 5000k	PC	08-LED-DDALS-N-ARM = Mounting Arm with Bracket

